

LED STREET LIGHTING CONTROLS



LED STREET LIGHTING CONTROLS



LED street lighting dimming feature helps to flexibly adapt street and outdoor lighting to the varied nightlife of cities and municipalities and enables significant energy savings. It offers three different control and dimming functions in single electronic control gear:

DALI – digital interface for bi-directional communication

ADIM – autonomous dimming

OPTION	DESCRIPTION
DALI	Driver with DALI interface
ADIM	Driver with autonomous mid-night dimming

ADIM – autonomous dimming is designed for dimming without any external control wiring and helps to save energy and reduce light pollution, even if only a power line is available. In ADIM operation, the street lighting fixtures executes a pre-set dimming profile, which can be factory programmed. The autonomous dimming is regulated by an integrated timer, which adjusts the dimming profile according to the previous night (operation from switch-on to switch-off).

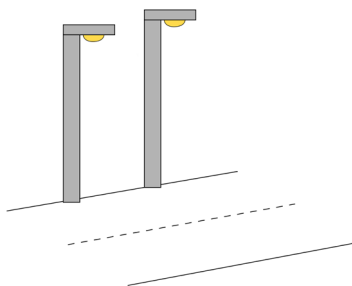

Installation without external control line for ADIM operation

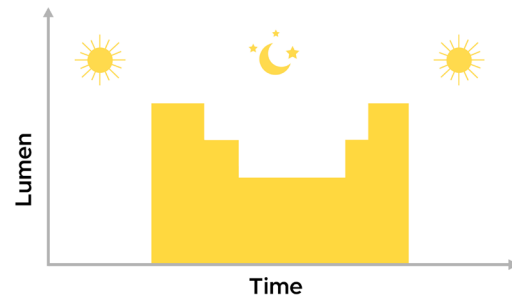

ADIM operation – light output over time: with one or two dim levels

Example: at 19 o'clock street lights are turned ON and at 6 o'clock turned OFF. In this case we have total of 11 hours long operation, middle point in this case is 5.5 hours which makes “natural midnight” at 00:30, so power goes down to 50% operation at 22:30 (00:30 – 2h), returns to 100% operation at 04:30 (00:30 + 4h). Power switch always takes average of last 4 operating times to calculate reference point. Energy savings about 70 percent. Higher energy savings can be achieved setting lower/longer operation level during night time or more power reduction steps. Please add this information when placing order.

AVAILABLE WITH*:



*For detailed information refer to luminaire family TDS

and others...

DALI ZHAGA18 (Option)

Luminaires prepared for Zhaga18 ready sensor



DESCRIPTION:	Driver with D4i interface and integrated ZHAGA18 socket. W/O sensor Body: PBT, black
GENERAL DATA:	Ingress protection: IP66 Impact protection: IK09 Operating temperature range, °C: according to product data sheet
INSTALLATION:	Build-in to the luminaire. Zhaga18 socket
ENVIRONMENT:	Outdoor
APPLICATION:	Park, public space, street

OPTION	DESCRIPTION	LENGTH, mm	WIDTH, mm	HEIGHT, mm
DALI ZHAGA18	Driver with D4i interface and integrated ZHAGA18 socket. W/O sensor, up	36,5	36,5	27,4
DALI ZHAGA18 DOWN	Driver with D4i interface and integrated ZHAGA18 socket. W/O sensor, down	36,5	36,5	27,4
DALI 2xZHAGA18	Driver with D4i interface and integrated two ZHAGA18 sockets. W/O sensor, up&down	36,5	36,5	27,4

Zhaga18 describes a smart interface between outdoor luminaires and sensing / communication nodes. It specifies power and communication aspects in addition to the mechanical fit and electrical pins. Zhaga18 allows any certified node to operate with any certified luminaire. Certified luminaires and sensing/communication modules are available from multiple suppliers, establishing an ecosystem of compatible products. The standard simplifies the addition of nodes such as sensors and communication nodes to LED luminaires. By assuring plug-and-play interoperability, the entire value chain benefits. It reduces complexity and adds value for the luminaire maker, installer and the specifier.

BLT ZHAGA18

Outdoor Bluetooth® Transceiver Node
Zhaga18 ready solution



DESCRIPTION: Outdoor Bluetooth® Transceiver Node
Body: polycarbonate, transparent

FEATURES: Grouping
Scenes
Calendar & Timer
Sunset & Sunrise
Control hierarchy
BLT app control

GENERAL DATA: Mains voltage: 220-240V, 50-60Hz
Life time, h: 100000
Ingress protection: IP66
Impact protection: IK09
Operating temperature range, °C: -40...+70
Control output: DALI
Power consumption: 0.16W
Required DALI current: 13mA

INSTALLATION: Build-in to the luminaire. Zhaga18 socket

ENVIRONMENT: Outdoor

APPLICATION: Park, public space, street

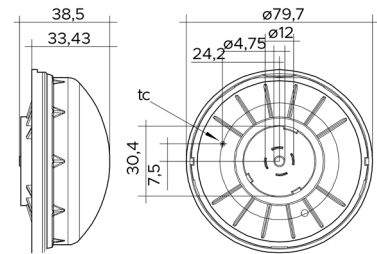

PRODUCT	LENGTH, mm	WIDTH, mm	HEIGHT, mm	CONTROL OUTPUT	BLUETOOTH® RANGE, m
BLT ZHAGA18 (basicDIM Wireless OTD)	80	80	38,5	DALI	<150

DETECTION DIAGRAM:

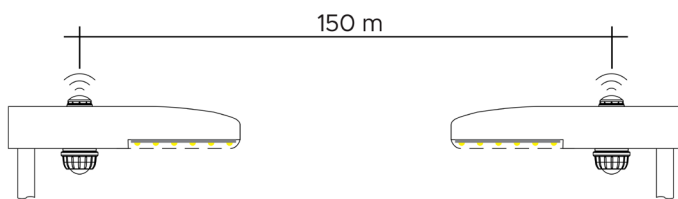

AVAILABLE WITH*:

Auva LED

Avior LED



*For detailed information refer to luminaire family TDS