

ATLAS M LED1X1500 D455 T830 LA1 SQUARE • 1101867

Product:	Atlas M LED1x1500 D455 T830 LA1 SQUARE
Order code:	1101867
Family:	Atlas M LED
Product group:	Outdoor accent lighting

GENERAL DATA

Description:	Ground-mounted LED luminaire Light distribution type: direct Optical system: lens, tempered glass diffuser, impact resistant Housing: aluminum, dark grey (RAL7043) Frame: stainless-steel, brushed
Installation:	In the ground. Cable, 1.0m, 3x1.5mm2
Environment	Outdoor
Application	public space, facade illumination

ELECTRICAL DATA

Mains voltage:	220-240V, 50/60Hz	System power*, W:	13.1
Power factor:	>0,90	Control gear:	ECG on/off
Integrated sensor:	None	Connection:	Cable, 1.0m, 3x1.5mm2

LIGHTING DATA

Light source and cap, W:	LED	Light source included:	yes
Luminaire output*, lm(ta+25°C):	1452	System efficacy, lm/W:	110
CRI (Ra):	80+	CCT, K:	3000
SDCM:	3	Light Distribution:	Asymmetrical
Distribution Type:	Direct	Beam angle, °:	Asymmetrical
LED lifetime, h:	40000/L80B50		

TECHNICAL DATA

Net weight, kg:	4.5	Quantity in package, pcs:	1
Packaging volume, m3/pcs:	0.0113	Pallet quantity, pcs:	80
Dimensions, mm:	200x200x235		

STANDARDS

Operating temperature range, °C:	-25...+40 C	Protection class IEC:	I
Ingress protection code:	IP67	Mechanical impact resistance:	IK10
EEC:	E	Certificates:	CE, RoHS
Warranty:	3 years		

Technical drawing (.jpg)

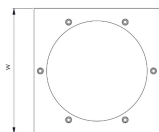
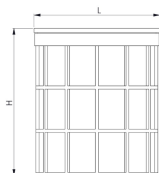

Light distribution curve (.jpg)

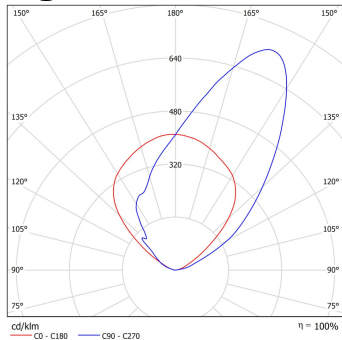

Note: Tolerance range for optical and electrical data: $\pm 10\%$. Values apply to an ambient temperature of 25 C. NORTHCLIFFE LIGHTING is constantly developing and improving its products. The right is reserved to change any product specifications without prior notification. Photos are for illustrational purposes only. The exact appearance of the product may vary depending on the monitor settings, options selected and other factors.