

TUBE M SR LED1X2000 D050 T840 L60 • 1020409

Image not found or type unknown

Product:	Tube M SR LED1x2000 D050 T840 L60
Order code:	1020409
Family:	Tube M LED
Product group:	Outdoor accent lighting

GENERAL DATA

Description:	Surface mounted LED wall washer Light distribution type: direct Optical system: lenses, tempered glass diffuser, impact resistant Housing: aluminium Colour: dark grey (RAL7043)
Installation:	On the wall or ceiling. Screw terminal, 3x1x1.5mm2
Environment	Outdoor
Application	facade illumination

ELECTRICAL DATA

Mains voltage:	220-240V, 50/60Hz	System power*, W:	19,4
Power factor:	>0,9	Control gear:	ECG on/off
Integrated sensor:	None	Connection:	Screw terminal, 3x1x1.5mm2

LIGHTING DATA

Light source and cap, W:	LED	Light source included:	yes
Luminaire output*, lm(ta+25°C):	2067	System efficacy, lm/W:	106
CRI (Ra):	80+	CCT, K:	4000
SDCM:	3	Light Distribution:	Symmetrical medium beam (31°...75°)
Distribution Type:	Direct	Beam angle, °:	68
LED lifetime, h:	60000/L80B10		

TECHNICAL DATA

Net weight, kg:	2.2	Quantity in package, pcs:	1
Packaging volume, m3/pcs:	0.0075	Pallet quantity, pcs:	120
Dimensions, mm:	155x155x250		

STANDARDS

Operating temperature range, °C:	-25...+40 C	Protection class IEC:	I
Ingress protection code:	IP65	Mechanical impact resistance:	IK08
EEC:	E	Certificates:	CE, RoHS
Warranty:	3 years (5 years – see warranty Ts and Cs)		

Technical drawing (.jpg)

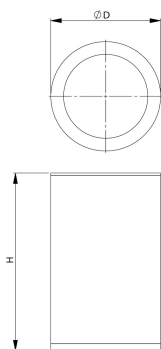

Light distribution curve (.jpg)

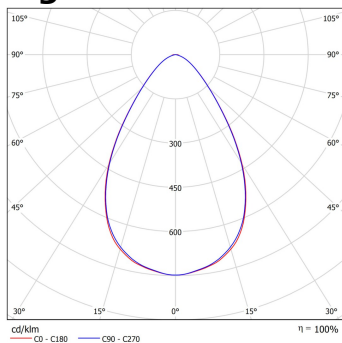

Note:

Tolerance range for optical and electrical data: $\pm 10\%$. Values apply to an ambient temperature of 25°C. NORTHCLIFFE LIGHTING is constantly developing and improving its products. The right is reserved to change any product specifications without prior notification

Date of issue: 2024-05-05 ■ NORTHCLIFFE LIGHTING, UAB ■ Raudondvario pl. 101, LT-47184 Kaunas, Lithuania ■ info@northcliffe.org ■ www.northcliffe.org