

**TUBE M LED2X1500 D043 T840 L30 • 1101834**

Image not found or type unknown

Product:	Tube M LED2x1500 D043 T840 L30
Order code:	1101834
Family:	Tube M LED
Product group:	Outdoor accent lighting

**GENERAL DATA**

<b>Description:</b>	Surface mounted LED wall washer Light distribution type: direct Optical system: lenses, tempered glass diffuser, impact resistant Housing: aluminium Colour: dark grey (RAL7043)
<b>Installation:</b>	On the wall or ceiling. Screw terminal, 3x1x1.5mm2
<b>Environment</b>	Outdoor
<b>Application</b>	facade illumination

**ELECTRICAL DATA**

<b>Mains voltage:</b>	220-240V, 50/60Hz	<b>System power*, W:</b>	26
<b>Power factor:</b>	>0,9	<b>Control gear:</b>	ECG on/off
<b>Integrated sensor:</b>	None	<b>Connection:</b>	Screw terminal, 3x1x1.5mm2

**LIGHTING DATA**

<b>Light source and cap, W:</b>	LED	<b>Light source included:</b>	yes
<b>Luminaire output*, lm(ta+25°C):</b>	2901	<b>System efficacy, lm/W:</b>	112
<b>CRI (Ra):</b>	80+	<b>CCT, K:</b>	4000
<b>SDCM:</b>	3	<b>Light Distribution:</b>	Symmetrical medium beam (31°...75°)
<b>Distribution Type:</b>	Direct	<b>Beam angle, °:</b>	38
<b>LED lifetime, h:</b>	60000/L80B10		

**TECHNICAL DATA**

<b>Net weight, kg:</b>	3.2	<b>Quantity in package, pcs:</b>	1
<b>Packaging volume, m3/pcs:</b>	0.0137	<b>Pallet quantity, pcs:</b>	60
<b>Dimensions, mm:</b>	200x155x464		

**STANDARDS**

<b>Operating temperature range, °C:</b>	-25...+40 C	<b>Protection class IEC:</b>	I
<b>Ingress protection code:</b>	IP65	<b>Mechanical impact resistance:</b>	IK08
<b>EEC:</b>	E	<b>Certificates:</b>	CE, RoHS
<b>Warranty:</b>	3 years (5 years – see warranty Ts and Cs)		

Technical drawing (.jpg)

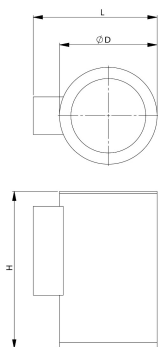

## Light distribution curve (.jpg)

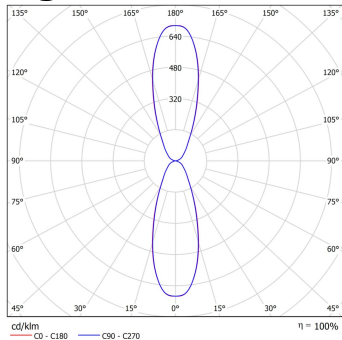

### Note:

Tolerance range for optical and electrical data:  $\pm 10\%$ . Values apply to an ambient temperature of  $25^{\circ}\text{C}$ . NORTHCLIFFE LIGHTING is constantly developing and improving its products. The right is reserved to change any product specifications without prior notification

Date of issue: 2024-05-05 ■ NORTHCLIFFE LIGHTING, UAB ■ Raudondvario pl. 101, LT-47184 Kaunas, Lithuania ■ [info@northcliffe.org](mailto:info@northcliffe.org) ■ [www.northcliffe.org](http://www.northcliffe.org)