

ANTLIA LED1X2400 D343 T840 • 1019677

Product:	Antlia LED1x2400 D343 T840
Order code:	1019677
Family:	Antlia LED
Product group:	Downlights

GENERAL DATA

Description:	Surface mounted LED downlight Light distribution type: direct Optical system: faceted aluminium reflector, 40°, low glare Housing: aluminum Colour: white (RAL9016)
Installation:	On the ceiling. Push-in terminal, 3x2x2.5mm2
Environment	Indoor
Application	office, education, corridor, retail, public place, showroom, hotel, bathroom, exhibition

ELECTRICAL DATA

Mains voltage:	220-240V, 50-60Hz	System power*, W:	19.8
Power factor:	0.95	Control gear:	ECG on/off
Integrated sensor:	None	Surge protection (L to N), kV:	1
Inrush current (Imax/time):	10A/ 200µs	Overvoltage protection:	.
Connection:	Push-in terminal, 3x2x2.5mm2		

LIGHTING DATA

Light source and cap, W:	LED	Light source included:	yes
Luminaire output*, lm(ta+25°C):	2463	System efficacy, lm/W:	124
CRI (Ra):	80+	CCT, K:	4000
SDCM:	3	Light Distribution:	Symmetrical medium beam (31 ...75)
Distribution Type:	Direct	Beam angle, °:	46
UGR index:	≤16	LED lifetime, h:	60000/L80B10
Ripple current (≤120 Hz), %:	≤1		

TECHNICAL DATA

Net weight, kg:	1	Quantity in package, pcs:	1
Packaging volume, m3/pcs:	0.0061	Pallet quantity, pcs:	140
Dimensions, mm:	168x168x172		

STANDARDS

Operating temperature range, °C:	ta 0...+35	Protection class IEC:	I
Ingress protection code:	IP20	Mechanical impact resistance:	IK02
EEC:	D	Certificates:	CE, UKCA, RoHS
Warranty:	3 years (5 years – see warranty Ts and Cs)		

Technical drawing (.jpg)

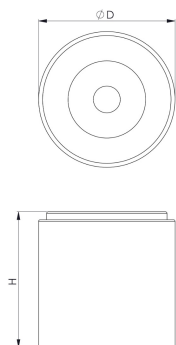

Light distribution curve (.jpg)

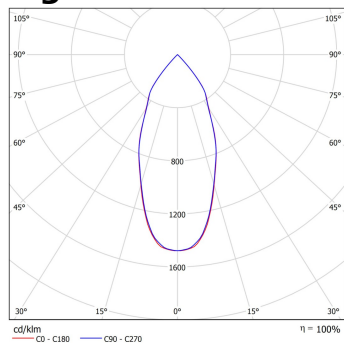

Note:

Tolerance range for optical and electrical data: $\pm 10\%$. Values apply to an ambient temperature of 25 C. NORTHCLIFFE LIGHTING is constantly developing and improving its products. The right is reserved to change any product specifications without prior notification. Photos are for illustrational purposes only. The exact appearance of the product may vary depending on the monitor settings, options selected and other factors.